

WEEKDAY SCHEDULE - SB

TIMEPOINTS	Route 41 Mohawk Ar. Martindale/Golflinks	Redeemer Route Lv. Martindale/Golflinks	Redeemer Route Arrive Redeemer U. C.	Redeemer Route Leave Redeemer U. C.	Redeemer Route Arrive Glancaster Loop	Route 34 Upper Paradise Leave Glancaster Loop	Route 44 Rymal Leave Garner/Glancaster
7 am	7:28 7:55	7:35 8:08	7:45 8:17	7:46 8:18	7:50 8:22	7:55 8:25	8:09 8:39
8 am	8:24	8:38	8:47	8:48	8:52	9:20	9:09
11am	11:46	11:45	11:55	12:06	12:10	12:20	-----
12pm	12:26	12:36	12:45	-----	-----	-----	-----
1 pm	1:06	1:06	1:15	1:15	1:19*	1:20	-----
4 pm	4:48	4:48	4:57	4:58	5:02	5:10	5:16
5 pm	5:18 5:48	5:18 6:00	5:27 6:09	5:30 6:09	5:34 6:13*	5:45 6:50	5:46 -----

SATURDAY SCHEDULE - SB

TIMEPOINTS	Route 41 Mohawk Ar. Martindale/Golflinks	Redeemer Route Lv. Martindale/Golflinks	Redeemer Route Arrive Redeemer U. C.	Redeemer Route Leave Redeemer U. C.	Redeemer Route Arrive Glancaster Loop	Route 34 Upper Paradise Leave Glancaster Loop	Route 44 Rymal Leave Glancaster Loop
9 am	9:45	9:50	10:00	10:00	10:04	10:15	-----
10am	10:44	10:45	10:55	10:58	11:02	11:15	-----
11am	11:28	11:32	11:42	11:42	11:46	12:15	-----
6 pm	6:08 6:36	6:08 6:40	6:17 6:50	6:17 -----	6:20 -----	6:20 -----	----- -----
7 pm	----- 7:16	7:08 7:40	7:18 7:50	7:18 -----	7:22 -----	7:23 -----	----- -----
8 pm	7:56 -----	8:08 8:40	8:18 8:50	8:18 8:50	8:22 8:54	8:23 -----	----- -----

* - Students on the bus can be dropped off at bus stops on Rymal Rd. and on Upper James as bus returns to the garage.

WEEKDAY SCHEDULE - NB

TIMEPOINTS	Route 34 Upper Paradise Arrive Glancaster Loop	Redeemer Route Leave Glancaster Loop	Redeemer Route Arrive Redeemer U. C.	Redeemer Route Leave Redeemer U. C.	Redeemer Route Ar. Martindale/Golflinks	Route 41 Mohawk Lv. Martindale/Golflinks
7 am	7:48	7:53	7:57	7:58	8:07	8:28
8 am	8:20 8:48	8:23 8:53	8:27 8:57	8:28 8:57*	8:37 -----	9:08 -----
11am	-----	11:28	11:34	11:34	11:44	12:02
12pm	12:13 -----	12:16 -----	12:20 -----	12:20 12:55	12:29 1:04	12:42 1:22
4 pm	4:33	4:33	4:37	4:37	4:46	4:52
5 pm	5:04 5:34	5:04 5:38	5:08 5:42	5:08 5:50	5:16 5:59	5:18 6:05

SATURDAY SCHEDULE - NB

TIMEPOINTS	Route 34 Upper Paradise Arrive Glancaster Loop	Redeemer Route Leave Glancaster Loop	Redeemer Route Arrive Redeemer U. C.	Redeemer Route Leave Redeemer U. C.	Redeemer Route Ar. Martindale/Golflinks	Route 41 Mohawk Lv. Martindale/Golflinks
9 am	-----	-----	-----	9:40	9:50	10:12
10am	10:08	10:10	10:14	10:15	10:25	10:52
11am	11:08	11:09	11:13	11:15	11:25	11:32
5 pm	-----	-----	-----	5:55	6:05	6:18
6 pm	6:09 -----	6:20 -----	6:24 -----	6:25 6:55	6:35 7:05	----- -----
7 pm	7:14 -----	7:22 -----	7:26 -----	7:26 7:55	7:36 8:05	7:38 8:18
8pm	8:14	8:22	8:26	8:26	8:36	8:58

Redeemer University College Transit Service

Effective September 6, 2011

No Sunday/Holiday Service

Redeemer University College

(R.U.C.) Transit Pass

Redeemer University College Student Senate and the HSR have established a Redeemer University College Transit Pass program.

Under the program, an annual fee is paid for a Redeemer University College Transit Pass validation sticker.

The program entitles R.U.C. students to unlimited, free use of all HSR regular service from September 6, 2011 to April 29, 2012.

R.U.C. students must show their Redeemer University College Student Photo I.D. Card (with the current validation sticker properly affixed) each time they board an HSR bus.



The Hamilton Street Railway Co.

Information: 905-527-4441

Website: www.hamilton.ca/hsr

Redeemer University College Route

How Do I Get To.....?

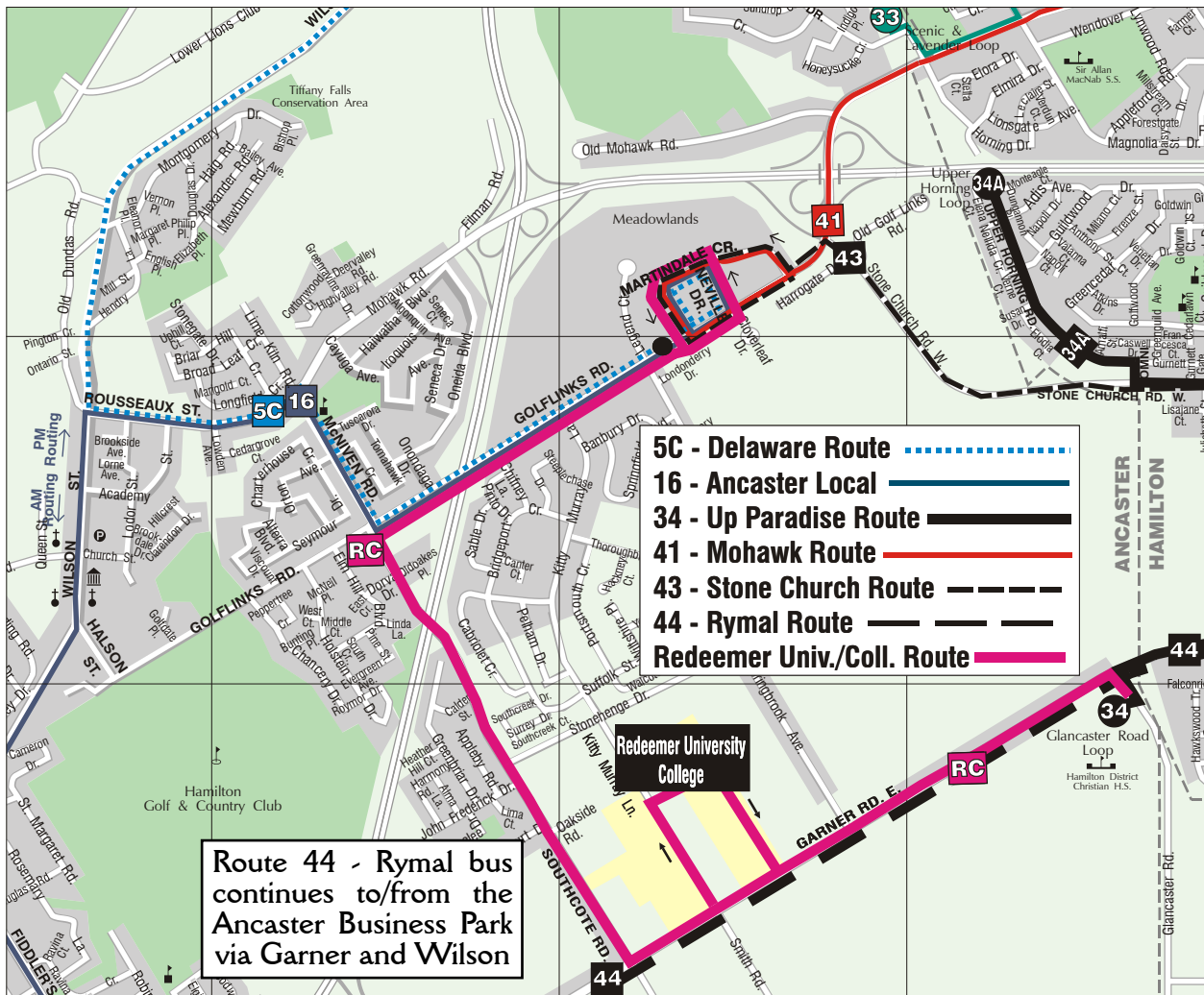

Lime Ridge Mall - Take the Redeemer bus to Martindale & Golflinks. Transfer onto the eastbound Mohawk-41 or Stone Church-43 bus. These buses travel right into the mall parking lot. The mall is on Upper Wentworth between Mohawk & the Lincoln Alexander Parkway.

Jackson Square - Take the Redeemer bus to the Glan-caster Loop. Transfer onto the northbound Upper Paradise-34 bus. This bus travels down the mountain and ends at King & James, right where Jackson Square is. Copps Coliseum, the Farmers Market and the Hamilton Public Library are all within walking distance.

Another option is to take the Delaware-5 bus to McMaster University (weekdays only) and continue your travel to downtown.

South Hamilton Square - Effective September 2009, Route 44 - Rymal will take you directly to South Hamilton Square or when that bus is not operating, take the Redeemer bus to Martindale & Golflinks. Transfer onto the eastbound Mohawk-41 bus. Get off this bus at Mohawk & Upper James. There are several stores here including No Frills, Metro and Canadian Tire. Catch the southbound Upper James-27 and get off at Rymal Rd. The South Hamilton Square has a Zellers, Fortinos, Starbucks, Winners and much more.

Don't be afraid to ask the Operator questions!

HSR Rules, Regulations & Programs

No Eating or Drinking On-Board - The HSR prohibits open cans, bottles or beverage containers on-board the bus. The same applies to food of any type, such as ice cream or chips.

No Smoking - Smoking is prohibited on the bus and in shelters in accordance with city by-laws.

Music on-board - Playing a radio is prohibited unless earphones are used.

Request Stop - After 8pm the Operator will let you off between bus stops. Simply ask the Operator at least one bus stop ahead of where you want to get off. The Operator will tell you if it is safe to stop there. If you use Request Stop, please leave by the front doors.

Fare Fraud - An Operator may confiscate any pass, ticket or identification card which he/she feels has been unlawfully produced, altered or otherwise tampered with so as to be used in a fraudulent manner.