

Authority: Item 1, Public Works,
Infrastructure and Environment
Committee Report 04-006
(PW04018)
CM: February 25, 2004

Bill No. 047

**CITY OF HAMILTON
BY-LAW NO. 04-047
TO INCORPORATE CITY LAND
DESIGNATED AS BLOCKS 45 AND 46 ON PLAN 62M-909 AND BLOCK 12 ON
PLAN 62M-954
INTO SILVERLACE CIRCLE**

WHEREAS the Council of the City of Hamilton is empowered under Section 31(1) of The Municipal Act, 2001, Chapter 25 and amendments thereto, to establish and lay out, widen, alter, divert, stop-up, lease or sell any highway or part of a highway;

AND WHEREAS the Council of the City of Hamilton deems it necessary to incorporate the land described below into the highway known as Silverlace Circle within its limits;

AND WHEREAS the said land is owned by the City of Hamilton;

NOW THEREFORE the Council of the City of Hamilton enacts as follows:

1. That the following land is hereby established and laid out as a public highway to form part of Silverlace Circle.

Blocks 45 and 46 on Plan 62M-909 and Block 12 on Plan 62M-954.

City of Hamilton

2. That the General Manager of Public Works or his duly authorized agent is hereby authorized to open the said land as a public highway.
3. That this by-law comes into force and takes effect on the date of its registration in the Land Registry Office (No. 62).

PASSED and ENACTED this 25th day of February, 2004

MAYOR

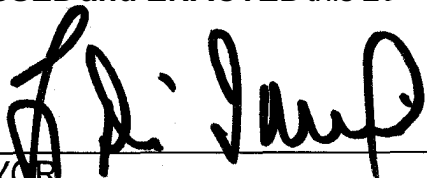

CLERK



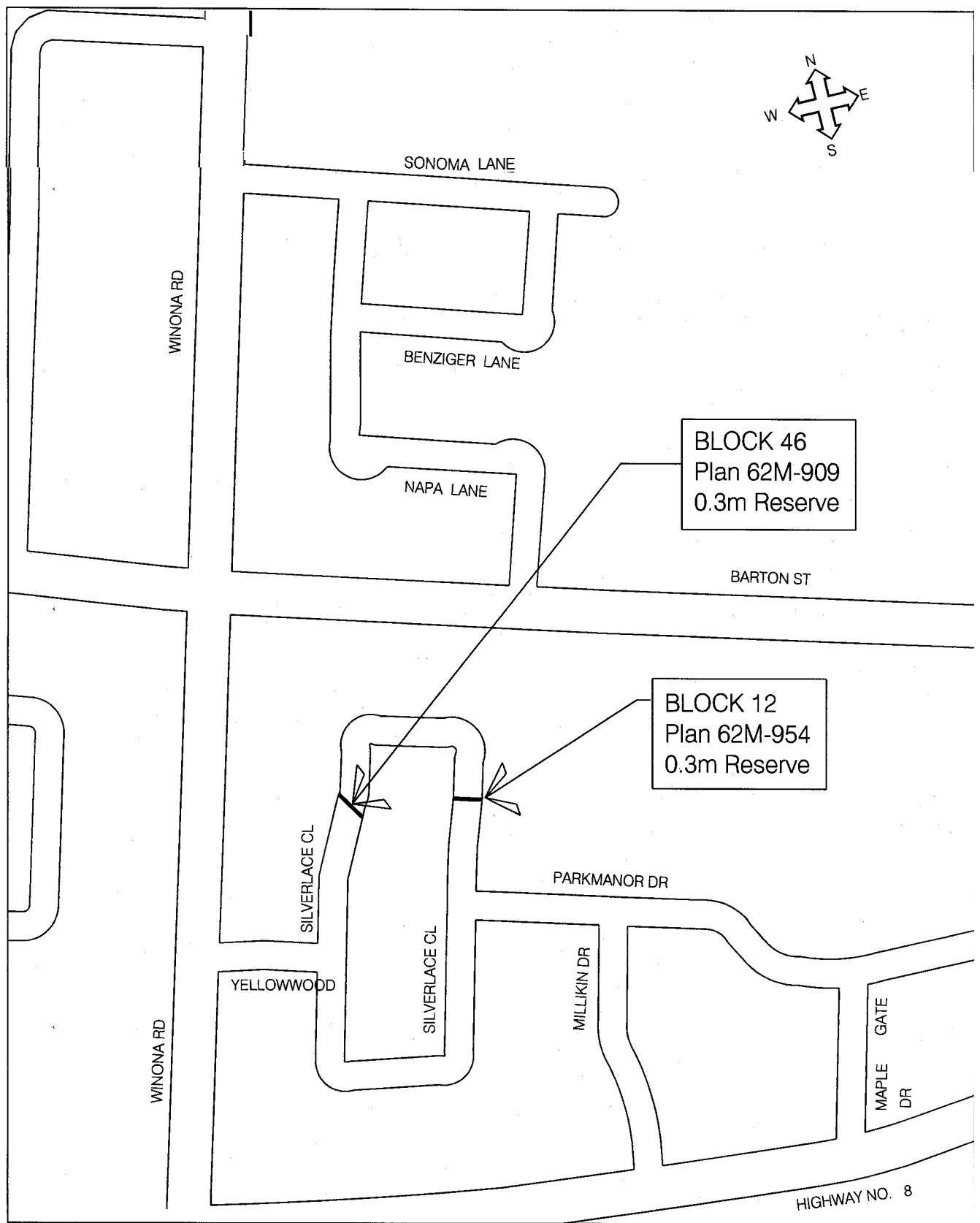
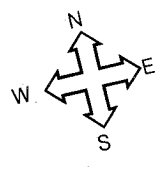

— Subject Lands

City of Hamilton
Silverlace Circle
Ward 11
Bylaw 04-047

CITY OF HAMILTON
Public Works Department
General Manager, Peter M. Crockett, P.Eng.

DATE: JANUARY, 2004

SCALE: N.T.S.