

Authority: Item 1, Public Works,
Infrastructure and Environment
Committee Report 04-006
(PW04018)
CM: February 25, 2004

Bill No. 049

**CITY OF HAMILTON
BY-LAW NO. 04-049
TO INCORPORATE CITY LAND
DESIGNATED AS PART 1 ON PLAN 62R-16620
INTO STONEHENGE DRIVE**

WHEREAS the Council of the City of Hamilton is empowered under Section 31(1) of The Municipal Act, 2001, Chapter 25 and amendments thereto, to establish and lay out, widen, alter, divert, stop-up, lease or sell any highway or part of a highway;

AND WHEREAS the Council of the City of Hamilton deems it necessary to incorporate the land described below into the highway known as Stonehenge Drive within its limits;

AND WHEREAS the said land is owned by the City of Hamilton;

NOW THEREFORE the Council of the City of Hamilton enacts as follows:

- 1 That the following land is hereby established and laid out as a public highway to form part of Stonehenge Drive.

Part of Block 86 on Plan 62M-895, designated as Part 1 on Plan 62R-16620.

City of Hamilton

2. That the General Manager of Public Works or his duly authorized agent is hereby authorized to open the said land as a public highway.
3. That this by-law comes into force and takes effect on the date of its registration in the Land Registry Office (No. 62).

PASSED 2nd ENACTED this 25th day of February, 2004

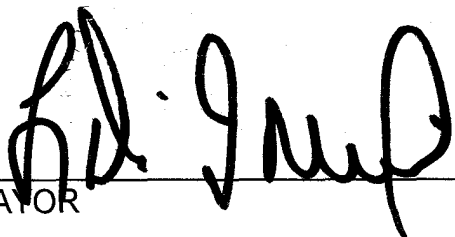

MAYOR



CLERK

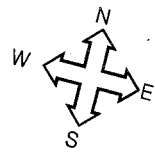
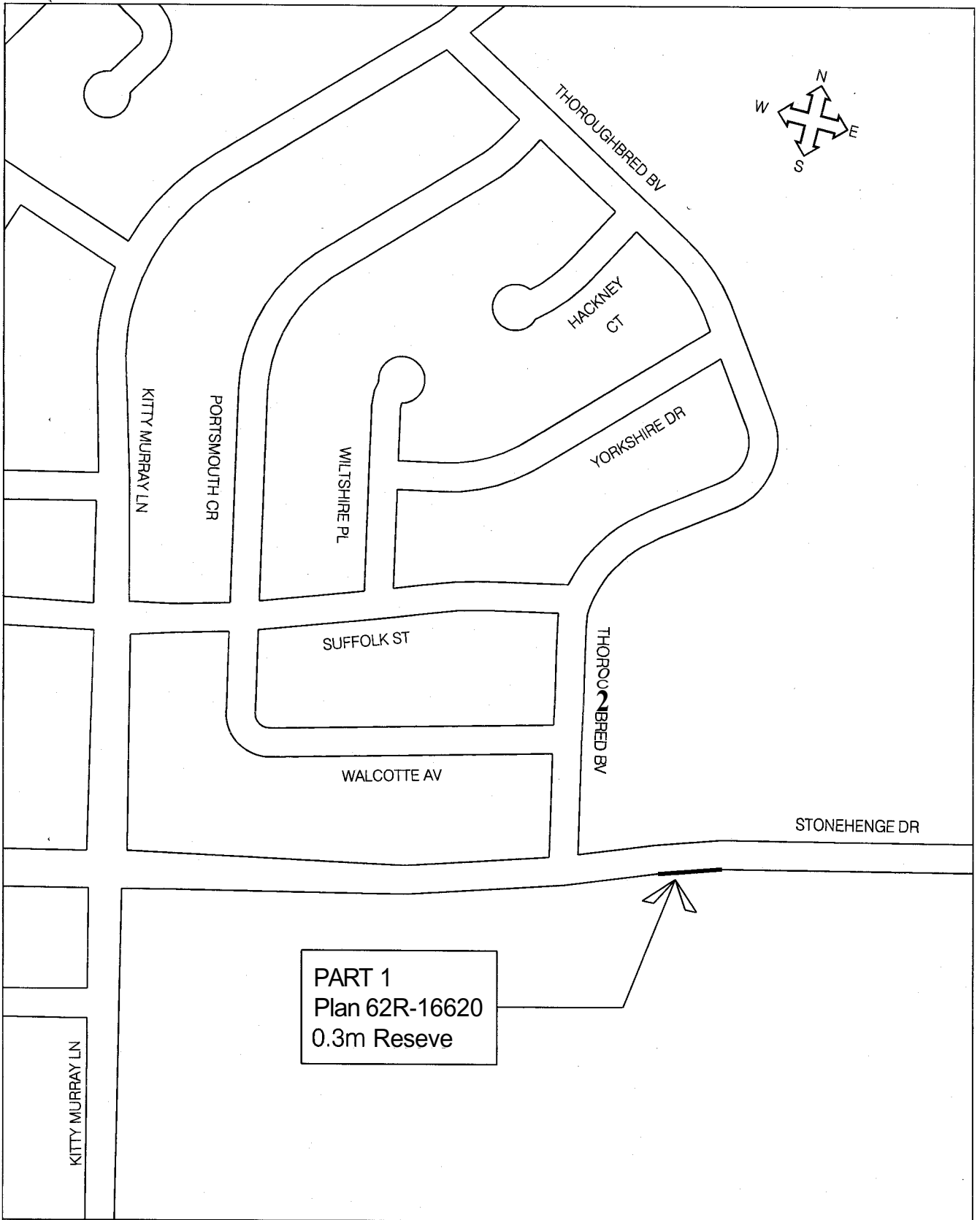

PART 1
 Plan 62R-16620
 0.3m Reseve

— Subject Lands

City of Hamilton
Stonehenge Drive
Ward 12
 Bylaw 04-049

CITY OF HAMILTON
 Public Works Department
 General Manager, Peter M. Crockett, P.Eng.

DATE JANUARY, 2004

SCALE N T S