

## WEST HARBOUR (JAMES ST N) GO STATION PUBLIC ART PROJECT



### Artist's Proposal

### *Bead Maze*

by **Laura Marotta**



### Artist's Concept Statement

This project will be a monumental bead maze. This very joyous replica serves as a monument to childlike imagination and elevates a familiar object from the everyday to the exceptional. As a child's toy, the bead maze provides a bright and cheerful outlet for children to play as well as develop their hand-eye coordination, visual tracking and colour recognition. Guiding wooden beads around the colourful wire maze can provide hours of stimulating fun. By changing the scale and context, this ordinary object takes on new meaning. In the plaza of the new James Street North GO Station this work will present itself as a quirky navigation tool, like a visual exercise in wayfinding and as a sculptural metaphor for mobility and transportation.

The piece is comprised of 28 multi-shaped and brightly coloured beads made from epoxy-coated aluminium that are stationed along three distinctly formed metal tubes that animate by curving, snaking, and spiraling through space. The colour and shape of the tubing is particular to this location: a grey tube, which traces the city infrastructure; a blue tube that spirals around, giving form to the open air; and a Metrolinx green tube, that snakes directly through the sculpture, evoking the maneuvering possibilities of the train within the urban landscape.

A bead maze is an early childhood toy, which demonstrates the mechanics of movement, transportation, and organization, while providing an emotional response of immediate delight. By scaling this universal toy up fifteen times, this sculpture will have a direct relationship to the body of the viewer and is designed to reinforce the various ways we connect with transportation. Beads are playfully positioned along the metal tubing as if they are swooping, sliding or have been brought to a complete halt. The organization of the beads suggests a network in motion, just like the daily train service from the new James Street North GO Station.

James Street North is a well-known epicentre for culture and style in Hamilton and the North End is valued as a child and family-friendly neighbourhood. This sculpture will reinforce those distinctive qualities and will serve to engage the imagination of community members, commuters, visitors, families and children. While it might reference a wayfinding schematic the purpose of this sculpture is not to direct you to any specific location. Instead it works to incite a more whimsical way for you to imagine moving through space. This sculpture will make a lasting contribution as a cultural landmark to the new GO Station and to this great neighbourhood.

# Site Plan

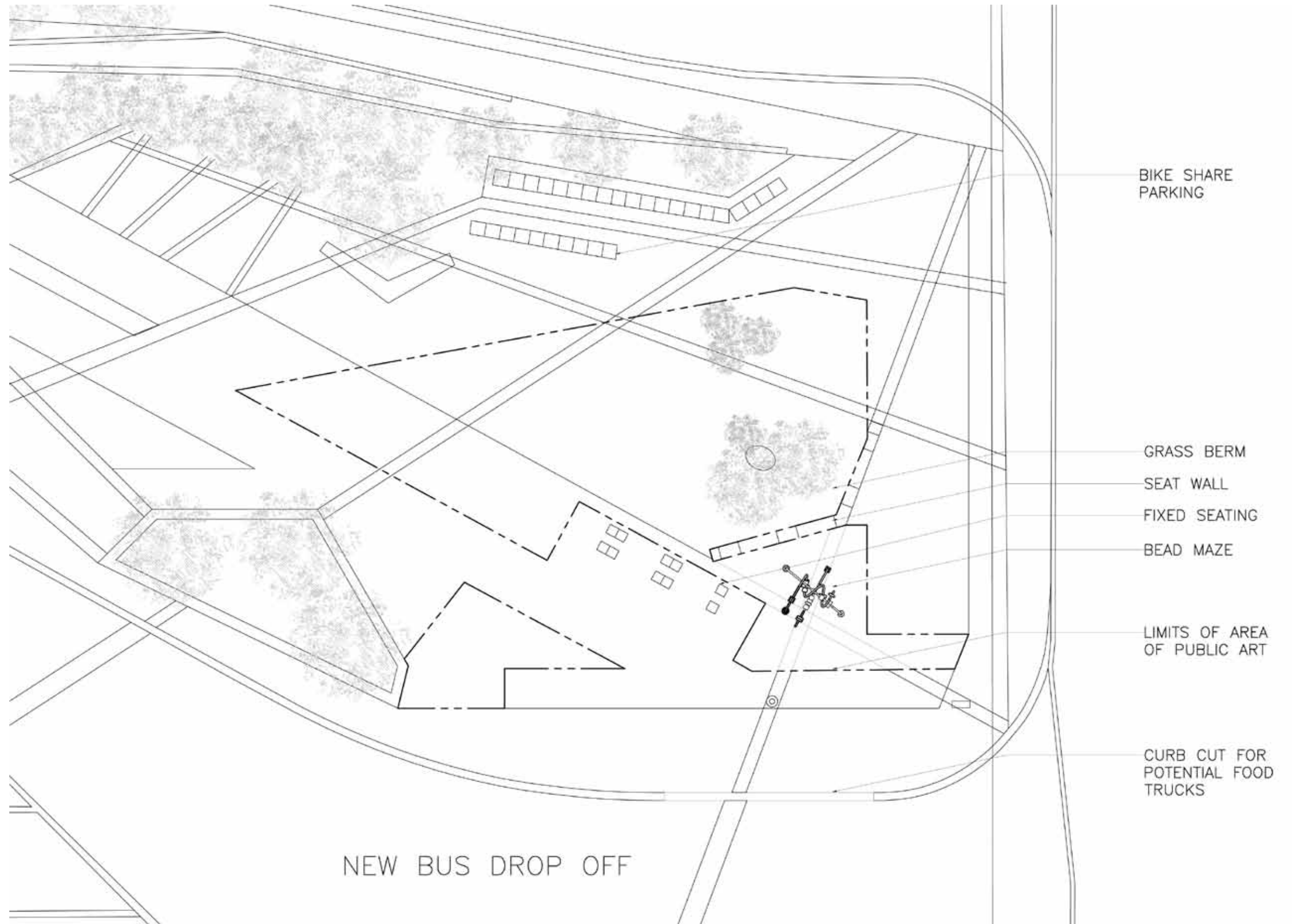

# 3D RENDERING

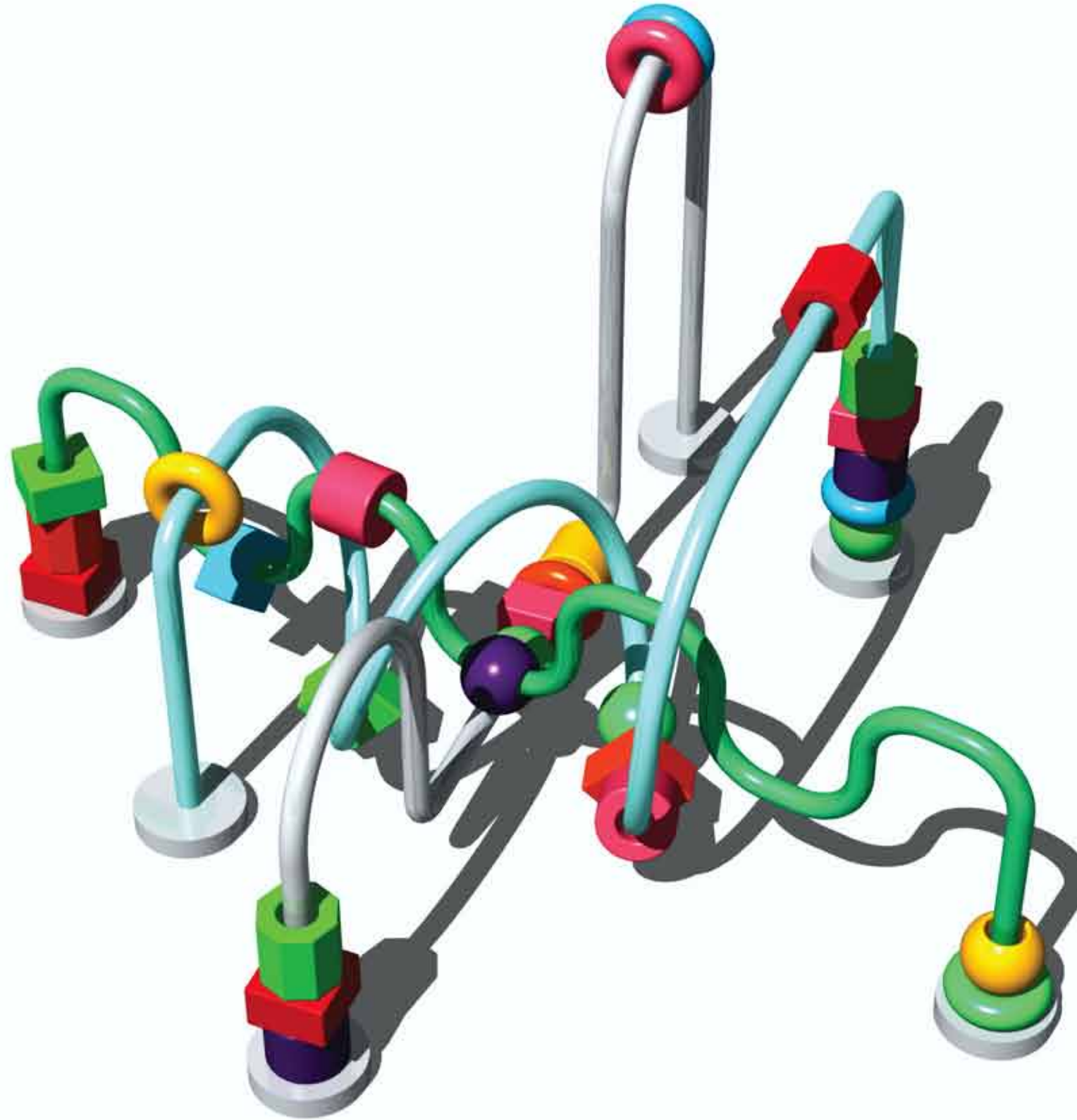

# Elevation Side

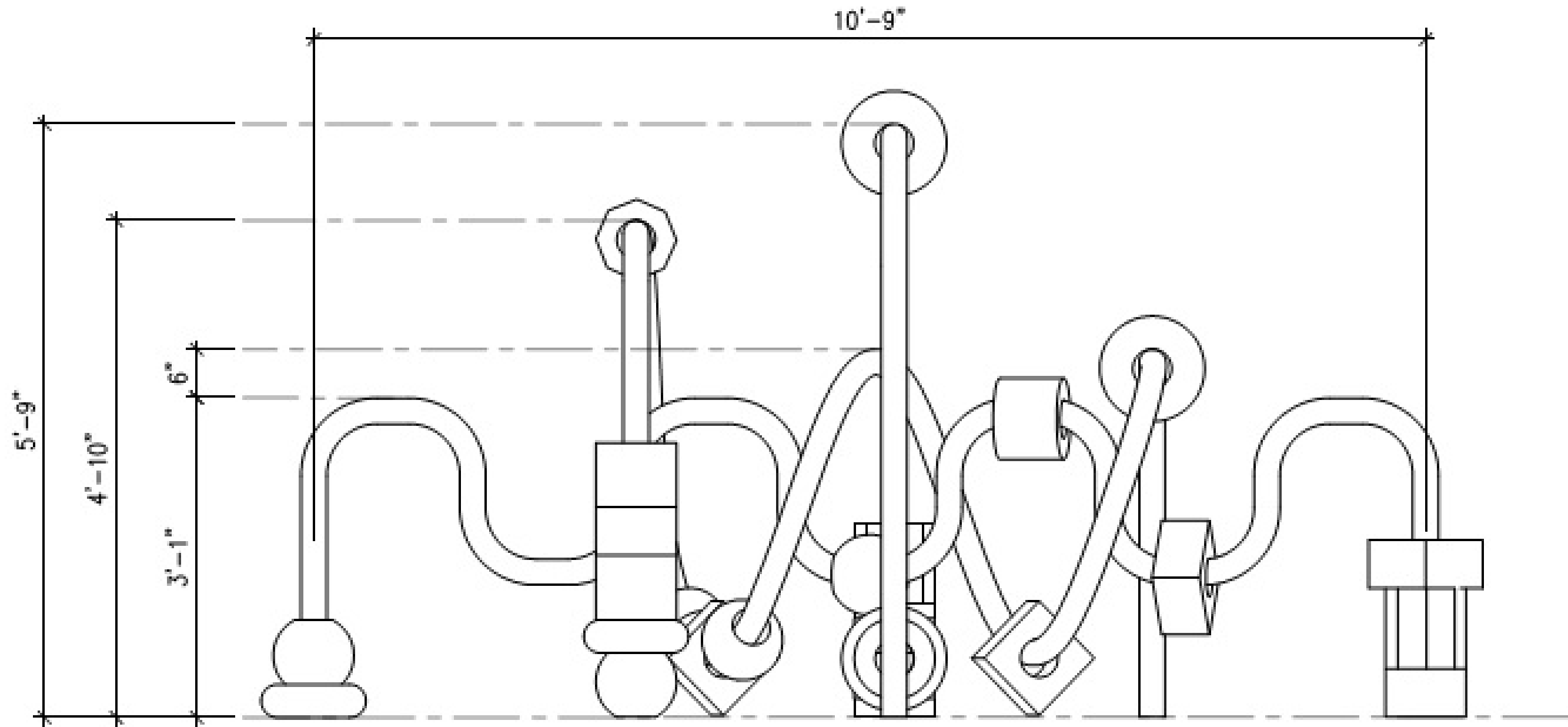

# Elevation Front

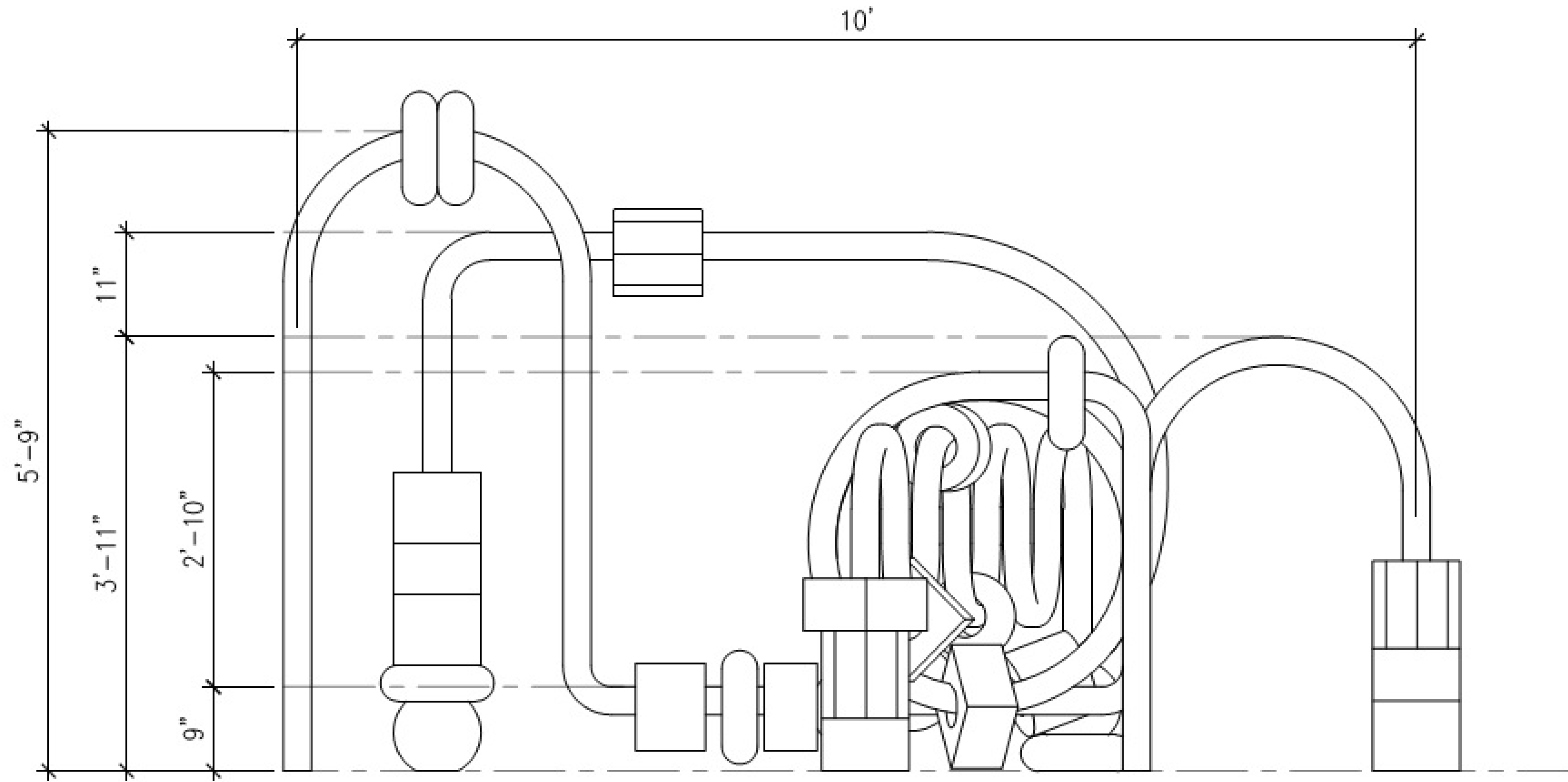

3D Rendering

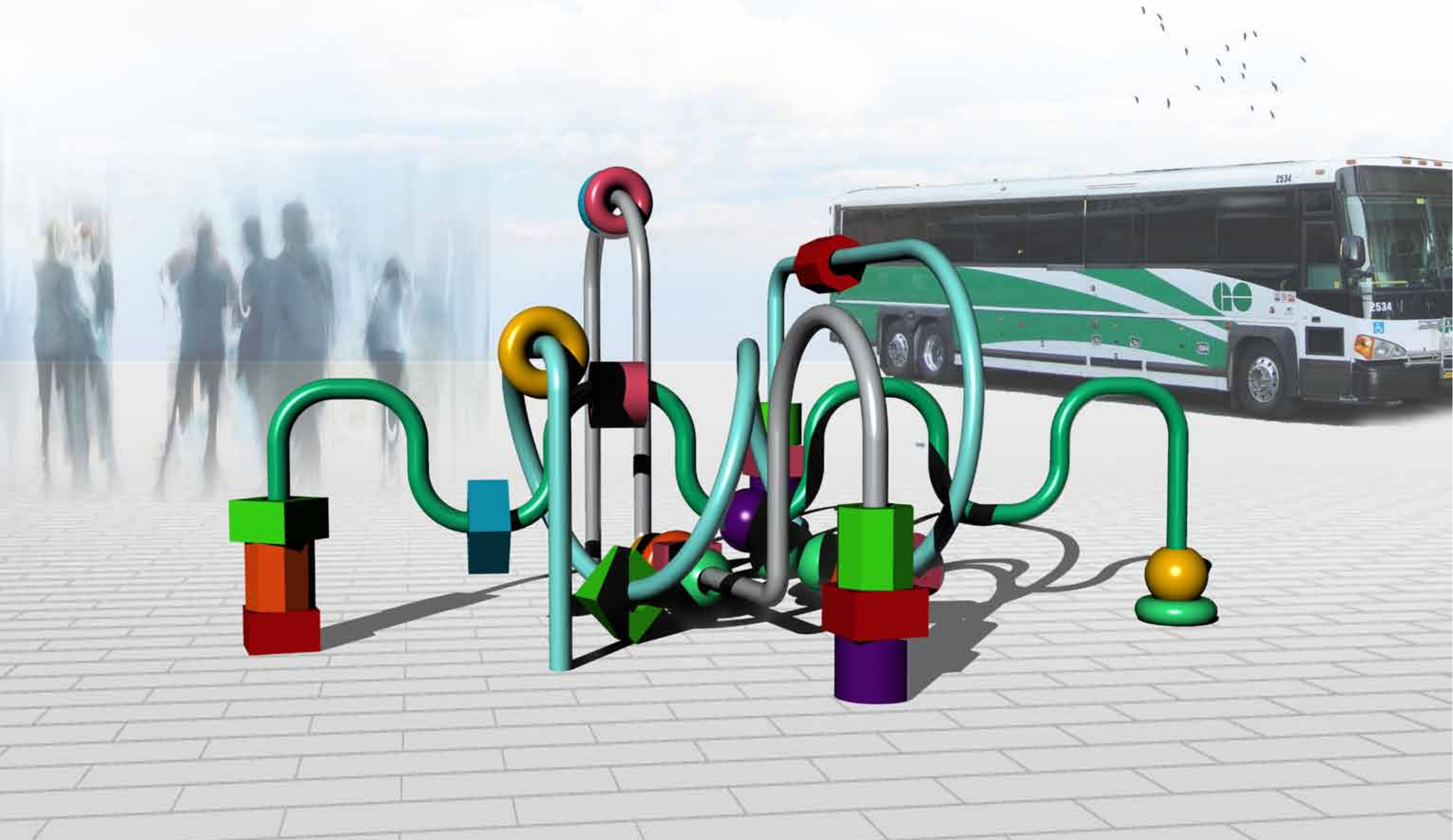

## 3D Rendering

