



DETOURS & CONSTRUCTION

11 PARKDALE DETOUR – BURLINGTON CANAL LIFT BRIDGE CLOSURE

FROM:	Thursday, January 5th, 2023 at 12:00 AM
TO:	Friday, March 31st, 2023 at 6:00 PM
WHERE:	Burlington Canal Lift Bridge
WHY:	Emergency Maintenance

NORTHBOUND TO BURLINGTON

From Beach Boulevard and Eastport Drive (after servicing Beach Boulevard), Left on Eastport Drive, Left on Beach Boulevard, Left on QEW/Burlington Skyway on-ramp opp. Van Wagner's Beach Road, Exit QEW at Highway 2/North Shore Boulevard, Left at North Shore Boulevard, Right on QEW Niagara/Eastport Drive, Continue south on Eastport Drive,

- For trips servicing CCIW, turn Right at CCIW main entrance roadway and resume regular routing.
- For trips not servicing CCIW, turn Left at CCIW main entrance roadway and resume regular routing.

SOUTHBOUND TO HAMILTON

From Lakeshore Road and Eastport Drive,

- For trips leaving CCIW, turn Left on Eastport Drive and follow instructions below,
- For trips not leaving CCIW, turn Right on Eastport Drive and follow instructions below,

Follow signs to North Shore Boulevard, Left on North Shore Boulevard, Right on QEW Niagara/Eastport Drive, Continue south on QEW/Burlington Skyway, Exit at Woodward Avenue off-ramp, Right on Woodward Avenue, Continue north on Eastport Drive, Right on Beach Boulevard (North intersection) and resume regular routing.





DETOURS & CONSTRUCTION

NORTH PORTION OF DETOUR

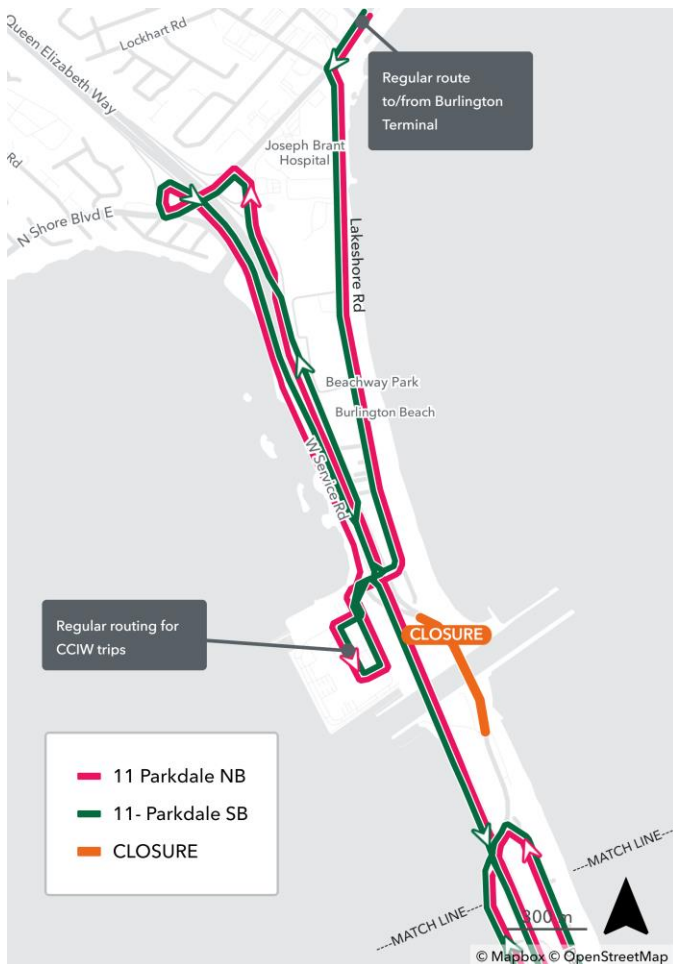

SOUTH PORTION OF DETOUR

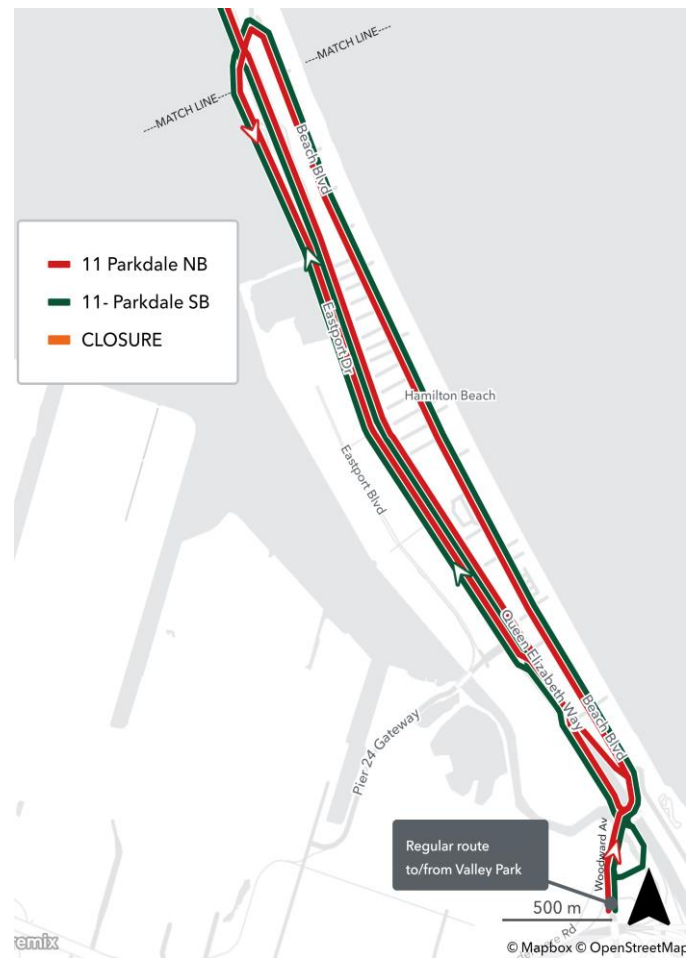

Note to Customers During this 3-month Burlington Canal Lift Bridge closure, an accident/high winds/snow storm/white out conditions may result in a closure of the Burlington Skyway. Should this occur, customers should consult HSR's Social Media channels or HSR Customer Service for updates and/or instructions on how to travel to/from Burlington, via downtown Hamilton.