

LOCATION PLAN

PROPOSED CLOSURE OF
UNASSUMED ALLEY ABUTTING
13 AVALON PLACE (PART A)
AND 11 AVALON PLACE (PART B)

CITY OF HAMILTON
PUBLIC WORKS DEPARTMENT

LEGEND



SUBJECT LANDS

DATE: April 4, 2019

Not to Scale

REFERENCE FILE NO : PW19_

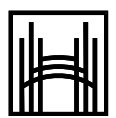
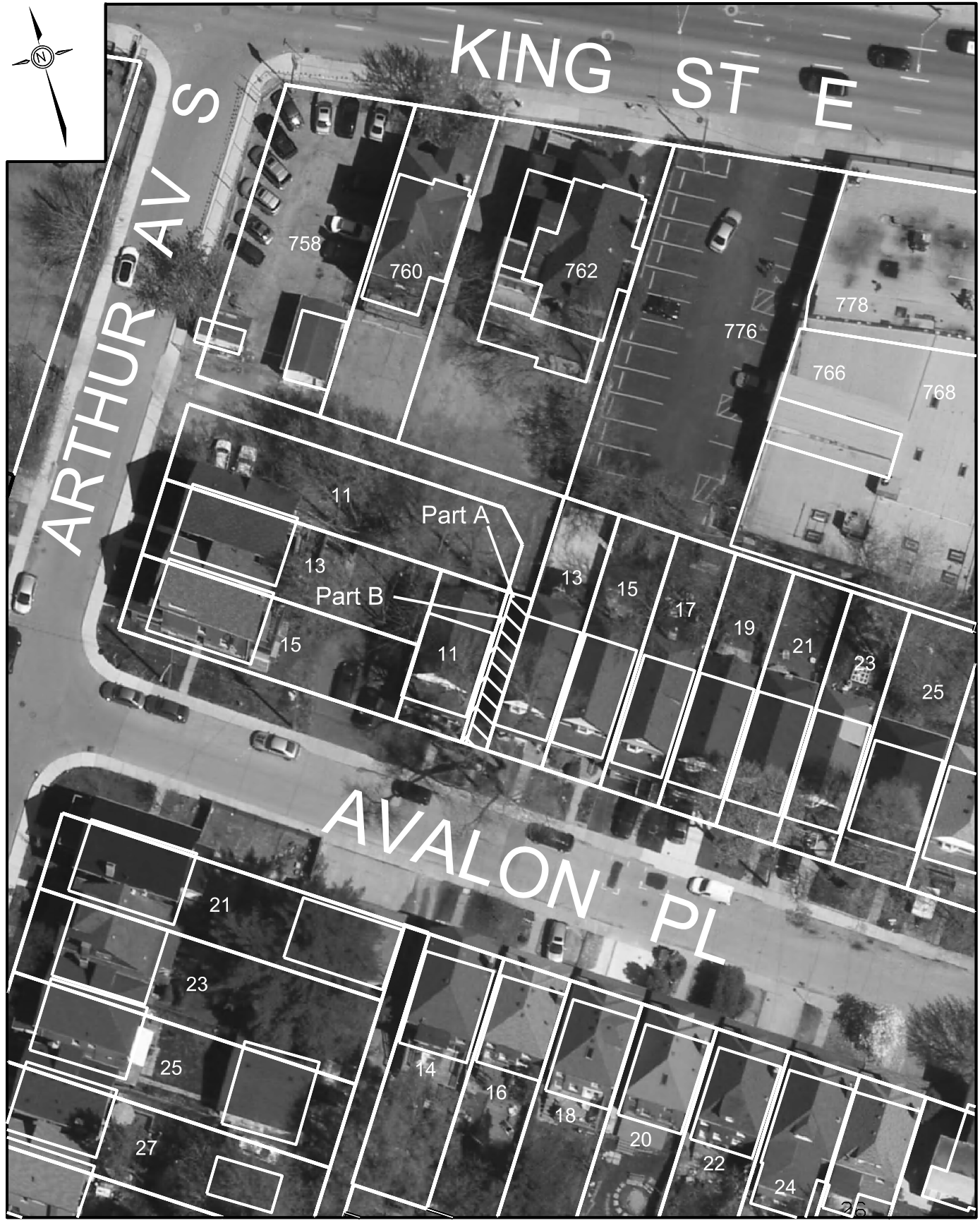

Hamilton

PROPOSED CLOSURE OF PORTION OF UNASSUMED ALLEY AT 13 AVALON PLACE (PART A) AND 11 AVALON PLACE (PART B)

Geomatics & Corridor Management Section
Public Works Department

LEGEND

 Lands to be Closed