

Authority: Item 2, Public Works
Infrastructure and Environment
Report 04-011 (PW04049)
CM: May 12, 2004

Bill No. 112

THE CITY OF HAMILTON

BY-LAW NO. 04- 112

**TO INCORPORATE CITY LAND
DESIGNATED AS PART 3 ON PLAN 62R-12942
INTO REGINA DRIVE**

WHEREAS the Council of the City of Hamilton is empowered under Section 31(1) of The Municipal Act, 2001, Chapter 25 and amendments thereto, to establish and lay out, widen, alter, divert, stop-up, lease or sell any highway or part of a highway.

AND WHEREAS the Council of the City of Hamilton deems it necessary to incorporate the land described below into the highway known as Regina Drive within its limits;

AND WHEREAS the said land is owned by the City of Hamilton.

NOW THEREFORE the Council of the City of Hamilton enacts as follows:

1. That the following land is hereby established and laid out as a public highway to form part of Regina Drive.

Part of Lot 14, Concession 8 in the Geographic Township of Barton, now in the City Of Hamilton. Designated as Part 3 on Plan 62R-12942.

City of Hamilton

2. That the General Manager of Public Works or his duly authorized agent is hereby authorized to open the said land as a public highway.
3. That this by-law comes into force and takes effect on the date of its registration in the Land Registry Office (No. 62).

PASSED and PASSED this 12th day of May, 2004

Mayor

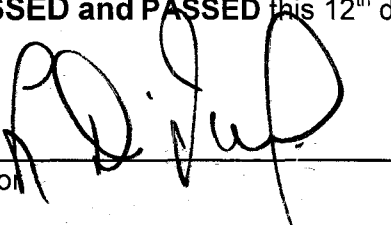

City Clerk



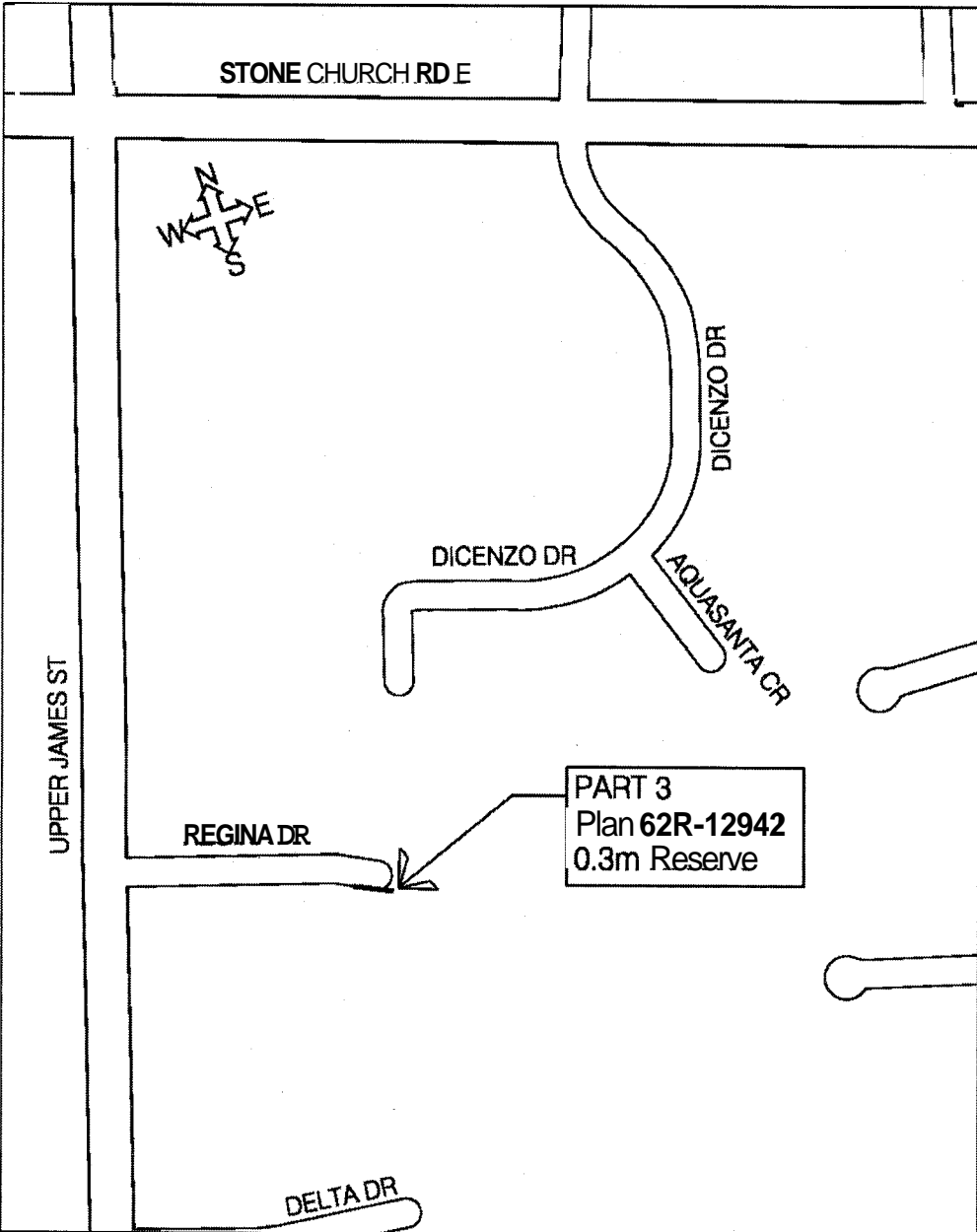

— Subject Lands

City of Hamilton
 Ward 7
 Regina Drive
 By-law

CITY OF HAMILTON
 Public Works Department
 General Manager, Peter M. Crockett, P.Eng.

DATE: APRIL 5, 2004

N.T.S.