

Authority: Item 3, Public Works, Infrastructure and Environment Committee Report 05-005 (PW05002a)  
CM: March 23,2005

Bill No. 067

**CITY OF HAMILTON  
BY-LAW NO. 05-067  
TO INCORPORATE CITY LAND  
DESIGNATED AS PARTS 1 AND 3 ON PLAN 62R-16832, PART 2 ON PLAN 62R-13866  
AND BLOCK 25 ON PLAN 62M-809  
INTO LORENZO DRIVE**

WHEREAS the Council of the City of Hamilton is empowered under Section 31(1) of The Municipal Act, 2001, Chapter 25 and amendments thereto, to establish and lay out, widen, alter, divert, stop-up, lease or sell any highway or part of a highway.

AND WHEREAS the Council of the City of Hamilton deems it necessary to incorporate the land described below into the highway known as Lorenzo Drive within its limits;

AND WHEREAS the said land is owned by the City of Hamilton.

NOW THEREFORE the Council of the City of Hamilton enacts as follows:

1. That the following land is hereby established and laid out as a public highway to form part of Lorenzo Drive.

Part of Lot 14, Concession 7 in the Geographic Township of Barton, now in the City of Hamilton. Designated as Parts 1 and 3 on Plan 62R-16832.

Part of Lot 13, Concession 7 in the Geographic Township of Barton, now in the City of Hamilton. Designated as Part 2 on Plan 62R-13866.

Block 25 on Plan 62M-809.

City of Hamilton

2. That the General Manager of Public Works or his duly authorized agent is hereby authorized to open the said land as a public highway.
3. That this by-law comes into force and takes effect on the date of its registration in the Land Registry Office (No. 62).

PASSED and ENACTED this 23<sup>rd</sup> day of March, 2005

MAYOR

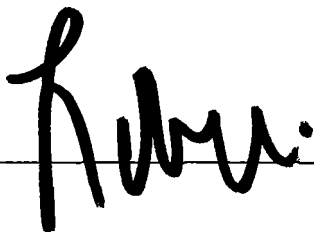

CLERK

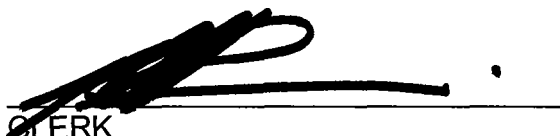

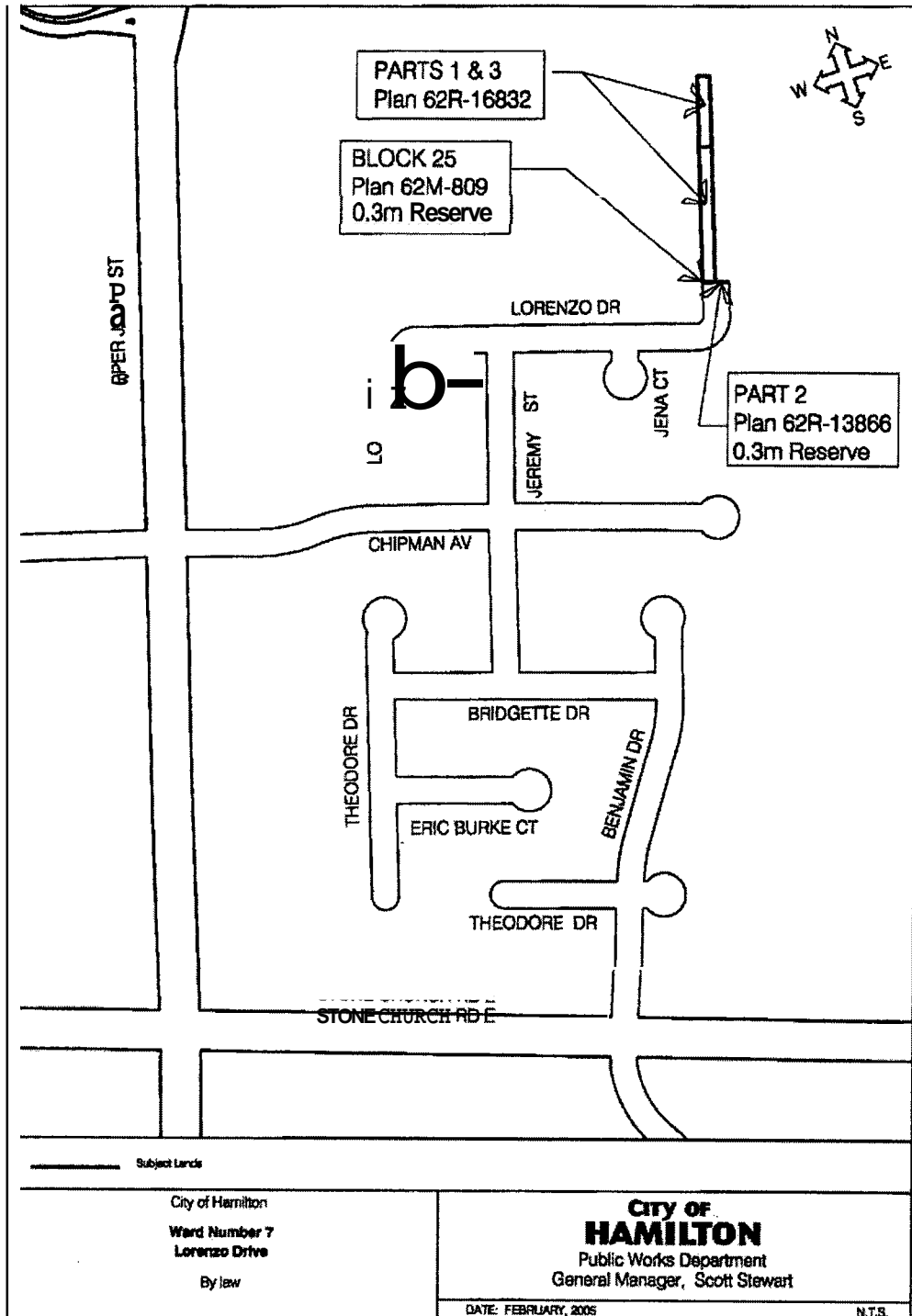

———— Subject Lands

City of Hamilton  
 Ward Number 7  
 Lorenzo Drive  
 By law

**CITY OF HAMILTON**  
 Public Works Department  
 General Manager, Scott Stewart

DATE: FEBRUARY, 2005

N.T.S.